

ASSEMBLY INSTRUCTIONS FOR ALTAIR POWER LOUVRE STANDARD HEIGHT - IN COMPONENT FORM

HEAD

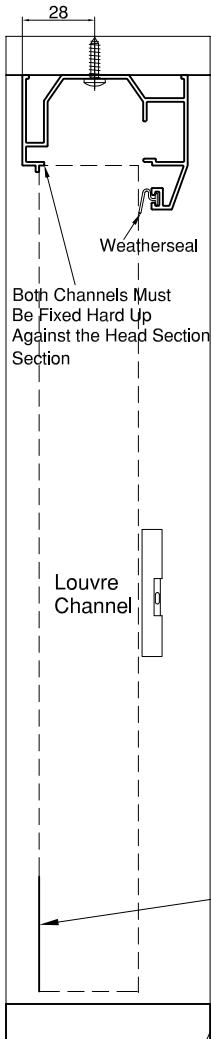

Apply Suitable Silicon To Underside Of Head Section Particularly Around The Screw Holes

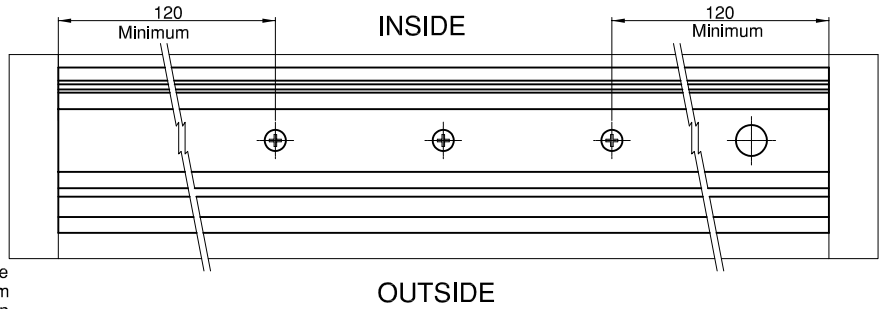
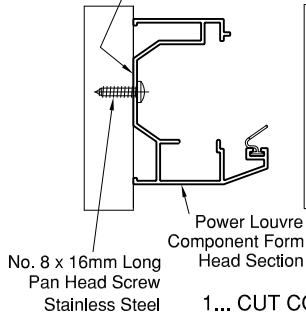

- 1... CUT COMPONENT FORM HEAD SECTION TO REQUIRED LENGTH (TO FIT INSIDE JAMBS)
- 2... DRILL 5Ø HOLES AT CENTRES SHOWN
DRILL 12Ø HOLE THROUGH HEAD AT OPPOSITE END TO MOTOR
- 3... INSERT SEAL THEN APPLY SUITABLE SILICON SEALANT TO TOPSIDE OF HEAD SECTION
- 4... SCREW HEAD SECTION INTO POSITION
- 5... TRANSFER 12Ø WIRING HOLE THROUGH WINDOW HEAD
- 6... HOLD LOUVRE CHANNEL WITH MOTOR ASSEMBLY IN POSITION IN THE HEAD SECTION.
USE A SPIRIT LEVEL TO ENSURE THAT THE LOUVRE CHANNEL IS PLUMB THEN MARK A LINE AT THE BOTTOM END OF CHANNEL.
- 7... REPEAT THIS PROCESS WITH THE OPPOSITE HAND CHANNEL
- 8... CUT WEATHERBAR TO REQUIRED LENGTH (TO FIT INSIDE JAMBS)
- 9... TRIM CORNERS AT 45° AS SHOWN (FOR DRAINAGE)
- 10... DRILL 5Ø HOLES AT CENTRES SHOWN THEN APPLY SUITABLE SILICON SEALANT TO UNDERSIDE OF WEATHERBAR
- 11... PLACE WEATHERBAR UPTO THE LINES PREVIOUSLY MARKED AND SCREW INTO PLACE
- 12... WITH THE WEATHERBAR IN PLACE APPLY SUITABLE SILICON SEALANT TO THE HORIZONTAL AND VERTICAL FACES ADJOINING THE JAMBS ON THE "OUTSIDE" AS SHOWN
- 13... PREPARE SNAP IN WEATHERSTRIP BY CUTTING TO LENGTH AND DRILLING WATER DRAIN HOLES AS SHOWN

SILL

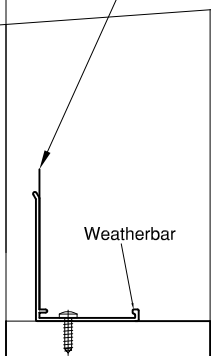

SILL

No. 6 x 20mm Long Stainless Steel Pan Head Screws

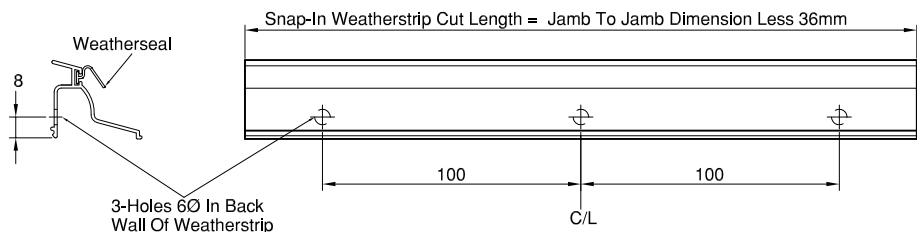
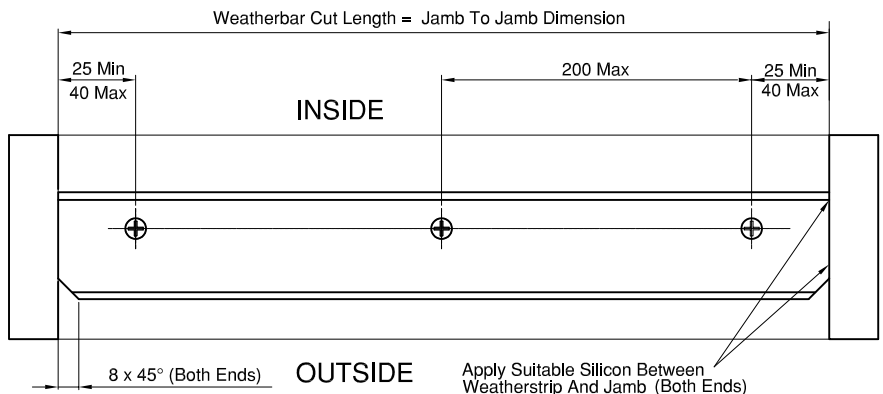
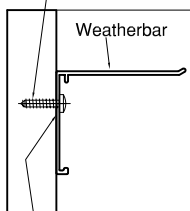

ASSEMBLY INSTRUCTIONS FOR ALTAIR POWER LOUVRE STANDARD HEIGHT - IN COMPONENT FORM

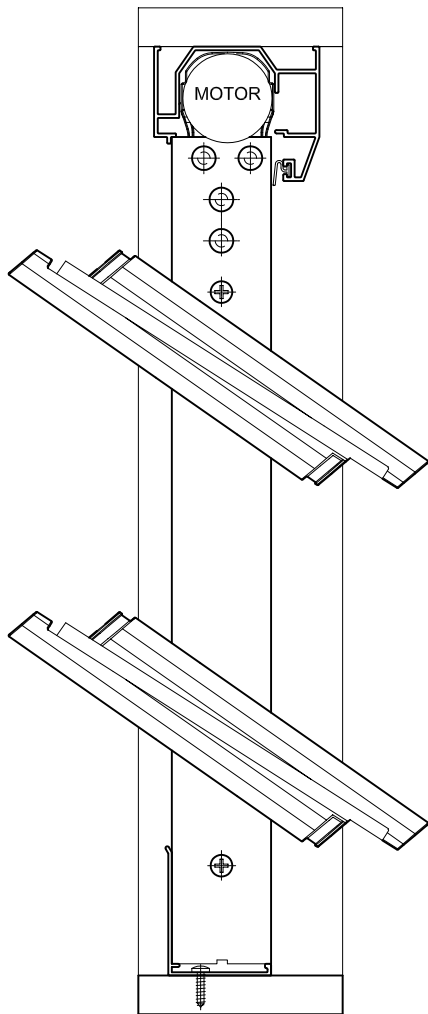

WINDOWS MUST BE OPEN
TO INSTALL BOTH SNAP-IN
WEATHERSTRIPS
A POWER SOURCE WILL
BE REQUIRED

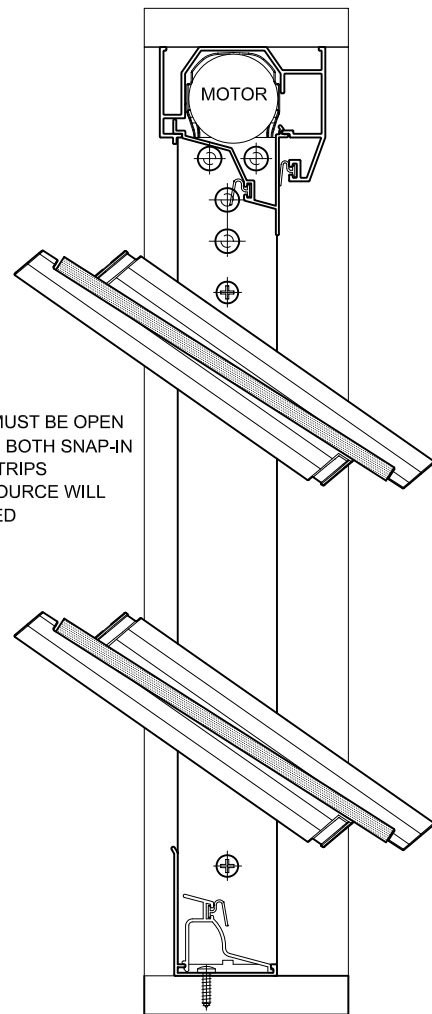

- 14... TAKE THE LEFT SIDE LOUVRE CHANNEL WITH MOTOR ATTACHED, PASS THE WIRE THROUGH THE 12Ø HOLE IN THE HEAD.
- 15... THEN PLACE THE LEFT SIDE CHANNEL WITH MOTOR UP TO THE LEFT JAMB(LEFT SIDE DRIVE IS STANDARD. RIGHT SIDE DRIVE CAN BE ORDERED) WITH THE HEAD SECTION AND THE HEAD OF THE CHANNEL HARD UP AGAINST THE HEAD SECTION AND THE SILL END ALIGNED WITH THE WEATHERBAR, SCREW THE CHANNEL INTO PLACE.
- 16... ALIGN THE OPPOSITE SIDE CHANNEL WITH THE OPPOSITE SIDE JAMB USING THE WEATHERBAR AND HEAD SECTION AS LOCATORS THEN SCREW INTO PLACE.
- 17... CUT THE HEAD WEATHERSEAL AS PER SILL WEATHERSEAL STRIP CALCULATIONS (NO DRAINAGE HOLES REQUIRED)

- 18... INSERT WEATHERSEALS INTO BOTH WEATHERSTRIPS AND SNAP THE APPROPRIATE HEAD AND SILL WEATHERSTRIPS INTO PLACE
- 19... SLIDE THE BLADES INTO POSITION IN THE CLIPS